



**PASSIVE INFRARED DETECTOR  
W/ PET IMMUNITY**

# **RX-40PI**



**Pet Immunity to Cats  
and Small to Medium  
sized Dog**

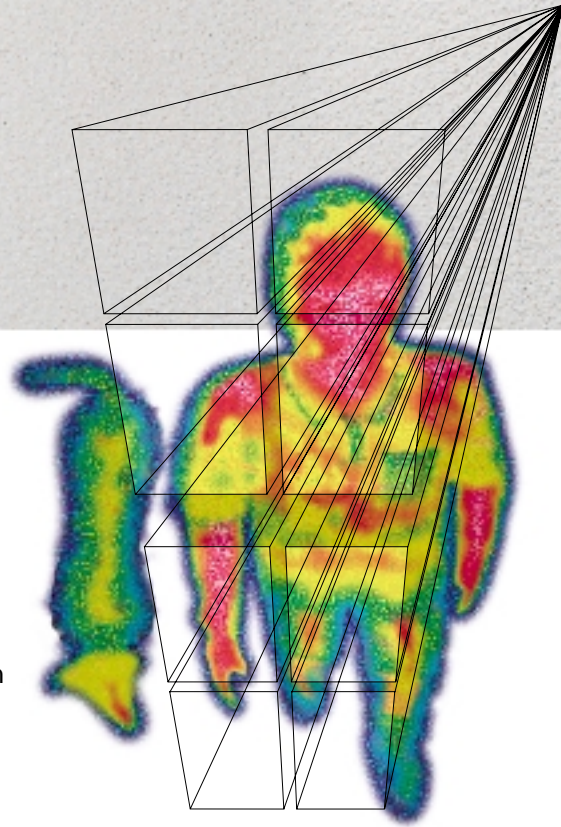

## **QUAD ZONE LOGIC**

Optex improves its patented "Multifocus Optics" technology to create "Quad Zone Logic" for accurate detection of humans. Using this logic the RX-40PI has been designed to give extremely high false alarm protection with tolerance to spot temperature changes from curtains or small to medium size animals. Optex's Optical Quad Technology uses taller detection zones divided into upper and lower areas. It detects IR energy changes in both areas and then couples them for extremely accurate detections. Offering very high reliability in hostile areas.

**5 YEAR WARRANTY**

# Passive Infrared Detector w/Pet Immunity

# RX-40PI

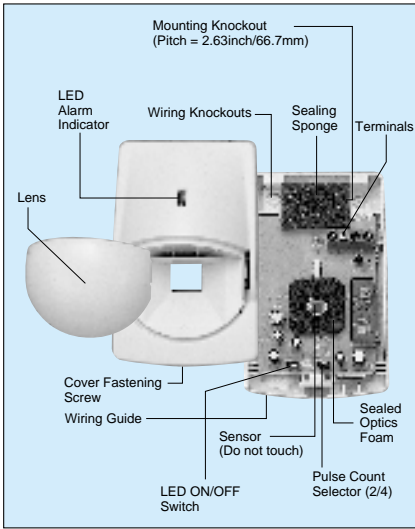

## FEATURES

### TECHNOLOGY FOR HIGHEST RELIABILITY

#### ●Quad Zone Logic - Recognized Humans and Ignores Most Small Animals

Quad Zone Logic provides multi segmented detection zones over the detection area. An alarm signal is created by the cumulated total IR energy of each zone. It is designed so that a human size target will normally fill 4 to 8 zones, and this will cause an alarm to be generated. Any smaller temperature change (i.e. small to medium size pets, rodents or moving curtains) only activates one or two zones at the same time creating a much weaker detection signal. Pet immunity applies to animals 0 to 16 inches in height. These signals are further analyzed by the "ECO" Chip and signal processing circuit for accurate detection of humans and avoidance of most small animals.

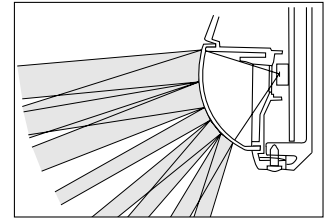
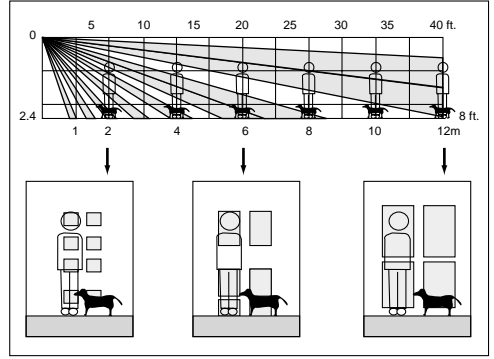

#### ●Spherical Lens

##### - Technology to Back Up Quad Zone Logic

Obtains an accurate focal length for each detection zone and maximizes the performance of Quad Zone Logic.

## TROUBLE-FREE & EASY INSTALLATION

●Sealed Housing  
Prevents drafts and insects from reaching the pyro element.

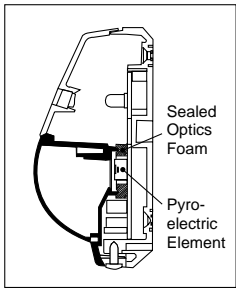

●Trouble-Free & Easy Knockouts  
Simply push with a screwdriver to open a hole of matching size with the cables.

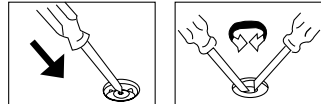

- Durable Spherical Lens and Housing Design
- Good Wiring Space and Guide
- Selectable Pulse Count : 2 or 4
- LED On/Off Switch

## PERFORMANCE

●RFI Protection  
No alarm at 20V/m from 100MHz to 1 GHz

●Temperature Compensation Logic  
Eco chip includes temperature compensation circuit. It controls sensitivity to improve stability against changes in environmental conditions.

#### ■Optional Multi-Angle Bracket

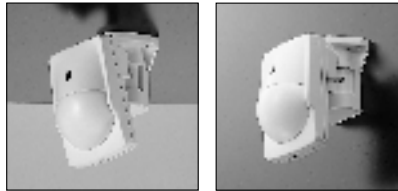

#### FA-3

Wall & Ceiling Mounting Bracket  
Horizontally ±45°, Vertically 0° to 15° downwards

#### FL-60N

Long Range (Extremely Dense Multi Layer Curtain Lens)  
(Pet Immunity is not available with FL-60N)

## DETECTION PATTERNS

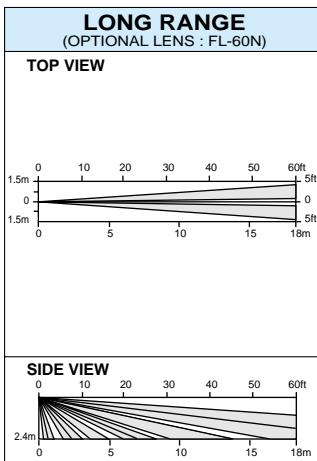
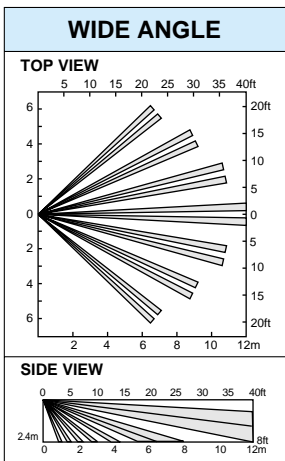

## SPECIFICATIONS

Model	RX-40PI
Detection Method	Passive Infrared
Coverage	Wide: 40ft x 40ft (12m x 12m), 85° wide
Detection Zones	Wide: 78 zones
Mounting Height	5 ~ 8ft (1.5 ~ 2.4m)
Sensitivity	3.6°F (2°C) at 2ft/sec. (0.6m/sec.)
Detection Speed	1 ~ 5ft/sec. (0.3 ~ 1.5m/sec.)
LED Alarm Indicator	Switchable On/Off
Alarm Period	Approx. 2.5 sec.
Alarm Output	N.C., 28VDC, 0.2A max.
Pulse Count	Approx. 20 sec. 2 or 4
Warm-up Period	Approx. 30 sec.
Power Input	9.5 ~ 16VDC
Current Draw	17mA (max.) at 12VDC
Weight	2.5 oz. (70g)
Operating Temperature	-4°F ~ +122°F (-20°C ~ +50°C)
Environmental Humidity	95% max.
RF Interference	No Alarm 20V/m

*FL-60N (Optional Lens for Long Range Curtain Pattern)	
Coverage	LONG: 60ft x 6ft (18m x 1.8m) Long Range
Detection Zones	LONG: 20 zones

## DIMENSIONS

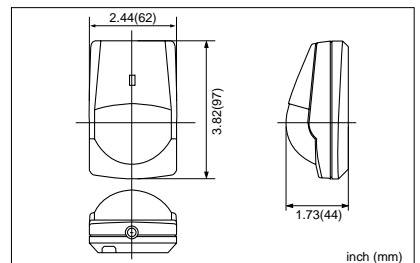

● Specifications and design are subject to change without prior notice.

NOTE: This unit is designed to detect movement of an intruder and activate an alarm control panel. Being only a part of a complete system, we can not accept responsibility for any damages or other consequences resulting from an intrusion. This product conforms to the EMC Directive. 89/336 EEC.  
NOTE: Pet immunity is effective only when the unit is installed according to the installation instructions supplied with the unit.



OPTEX CO., LTD. (ISO 9001 Certified by LRQA)  
4-7-5 Nionohama Otsu, 520-0801 Japan  
TEL(077)524-6047 FAX(077)522-9022

#### OPTEX AMERICA, INC.

1845 W. 205th St. Torrance, Ca. 90501-1510 U.S.A.  
TEL(310)533-1500 FAX(310)533-5910

#### OPTEX (EUROPE) LTD. (ISO 9002 Certified by NQA)

Clivemont Road, Cordwallis Park, Maidenhead, Berkshire, SL6 7BU U.K.  
TEL(01628)631000 FAX(01628)636311

